

HabasitLINK[®] M5060 Flat Top 2"



Your Source For Habasit
Belting And Chain

www.StilesEnterprises.com • 1-800-325-4232

Description

- 0% open area
- Solid plate
- Imperial belt width
- Dynamic open hinge, easy to clean
- Strong link design (1" link-pitch)
- Rod diameter 7 mm (0.27")
- Smart Fit rod retention
- Food approved materials available

Available accessories

- Flights

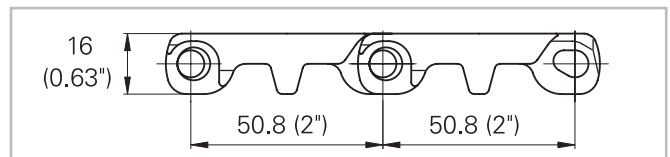
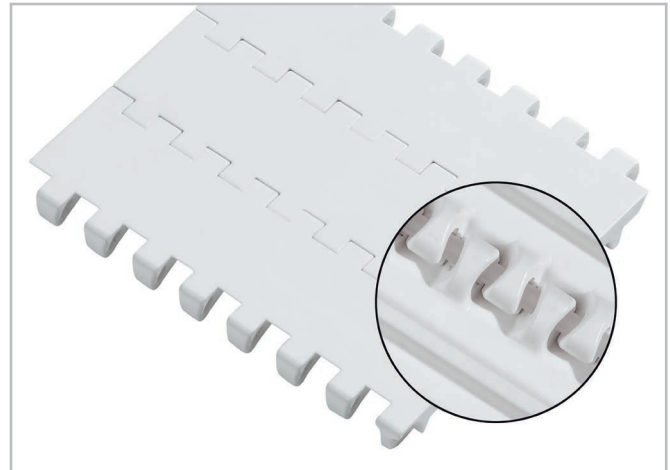

Belt data

Belt material		PP		PE	
Rod material		PP	PA	PE	PA
Nominal tensile strength F' _N straight run	N/m	18000	22000	8000	10000
	lb/ft	1233	1507	548	685
Temperature range	°C	5 - 105	5 - 105	-70 - 65	-46 - 65
	°F	40 - 220	40 - 220	-94 - 150	-50 - 150
Belt weight m _B	kg/m ²	8.8	8.8	9.1	9.1
	lb/sqft	1.8	1.8	1.86	1.86

Belt material		POM		POM +IM	
Rod material		PE	PA	PE	PA
Nominal tensile strength F' _N straight run	N/m	14000	30000	14000	30000
	lb/ft	959	2055	959	2055
Temperature range	°C	-40 - 65	-40 - 93	-40 - 65	-40 - 93
	°F	-40 - 150	-40 - 200	-40 - 150	-40 - 200
Belt weight m _B	kg/m ²	13.1	13.1	13.1	13.1
	lb/sqft	2.68	2.68	2.68	2.68

Diameter of idling rollers (minimum)		Diameter of support rollers (minimum)		Diameter for gravity take-up and center drive rollers (minimum)		Backbending radius for elevators without side guards or hold down devices (minimum)		Backbending radius for elevators with sideguards or hold down devices (minimum)	
mm	inch	mm	inch	mm	inch	mm	inch	mm	inch
90	3.5	100	4	150	6	150	6	250	10

Use the largest possible backbending radius for elevators with side guards or hold down devices.

Standard range of belt widths b₀

mm (nom.)	101	152	203	254	304	356	406	457	508	559	609	660	711	etc.
inch (nom.)	4.0	6.0	8.0	10.0	12.0	14.0	16.0	18.0	20.0	22.0	24.0	26.0	28.0	etc.

Real belt widths are in most cases 0.1% to 0.3% smaller.

Standard belt widths in increments 4.0" (101 mm). Non-standard widths are offered in increments of 1.0" (25.4 mm) Smallest possible width 4.0" (101 mm).